

B-4005 General Specifications

Performance		
*Ram Weight X Max. Stroke	57,500 ft•lb	78 kN•m
Impact energy	35,900 ft•lb	49 kN•m
Ram weight/mass	5,000 lb	2,300 kg
Maximum ram stroke	11.5 ft	3.5 m
Impact block weight/mass	1,326 lbs	601 kg
Blows per minute	36-60	36-60
Operating Weight		
Total operating weight/mass	16,000 lb	7,258 kg
Weight of tool box	150 lb	68 kg
Total shipping weight/mass	16,150 lb	7,326 kg
Capacity		
Fuel tank capacity	20 gal (U.S)	76 liters
Fuel consumption	2.1gal/hr.	7.9 liters/hr.
Oil tank capacity	6.1gal (U.S)	23 liters
Oil consumption	0.24 gal/hr.	0.9 liters/hr.



Impact Hammers B-4005

Dimensional Specifications

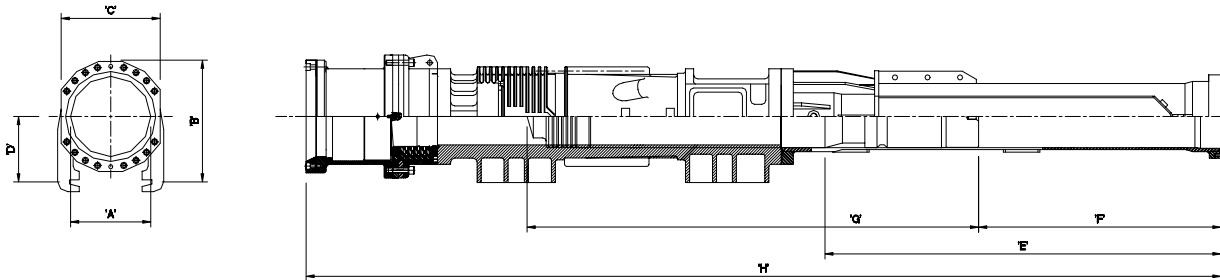

Dimensions		Model-4505						
Units	A	B	C	D	E	F	G	H
Imperial	21.5 in	34in	26in	18in	110 in	71.8 in	111.5 in	228.5 in
Metric	546 mm	864mm	660mm	457mm	2794 mm	1824 mm	2832 mm	5804 mm

B-4005 5000 lb Piston					
BPM	Stroke (ft)	Potential Energy (ft.lb)	Velocity (ft/s)	Maximum Impact Force (tons)	Impact Energy (ft.lb)
35	11.8	59,000	22.5	406	41,300
36	11.2	56,000	22.0	397	37,600
37	10.6	53,000	21.5	388	35,900
38	10.0	50,000	21.0	379	34,200
39	9.5	47,500	20.5	370	32,600
40	9.0	45,000	20.0	361	31,000
41	8.6	43,000	19.5	352	29,500
42	8.2	41,000	19.0	343	28,000
43	7.8	39,000	18.5	334	26,600
44	7.5	37,500	18.0	325	25,200
45	7.1	35,500	17.5	316	23,800

Stroke height is a function of soil resistance and may not be attainable in certain driving conditions.
 Standard Operating Range.

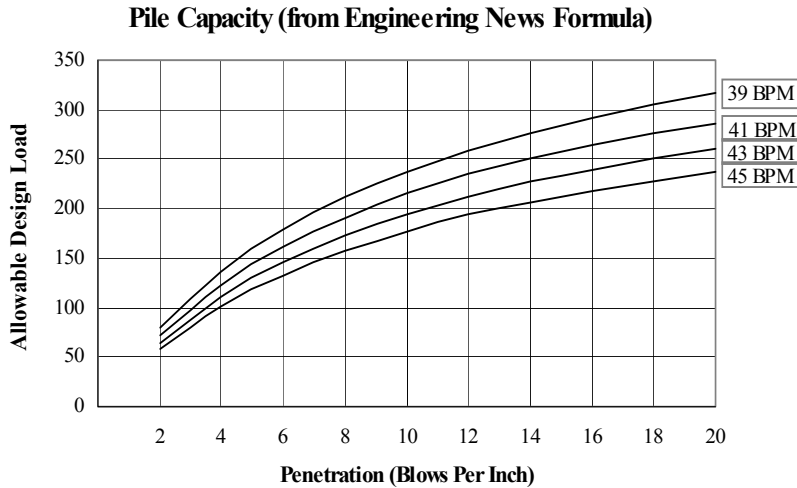

WEAP Input Data

Ram			Stroke				
Weight	Length	Diameter	Maximum	Minimum	Efficiency		
5.00 Kips	111.50 in	15.11 in	11.80 ft.	4.00	0.800		
Impact Block Information							
Weight	Length	Diameter	C.o.R	RoundOut			
1.33 Kips	27.25 in	14.80 in	0.900	0.0100			
Diesel Hammer Combustion Chamber Information							
Combustion Chamber Inf.			Combustion		A I Volume		
C-Stroke	Area	Volume	Delay	Duration	ExpCoef	Ignition	Fin.Comb
15.75 in	185.15 in ²	239.00 in ³	0.000	0.000	1.250	262.9 in ³	315.5 in ³
Pressure							
Atmosphere	FS 1	FS 2	FS 3	FS 4	FS 5	Coeff Conf	
14.70	1400 psi	1300 psi	1200 psi	1100 psi	1000 psi	1.0	
Helmet And Hammer Cushion Properties							
Helmet		Hammer Cushion					
Weight	Material	WEAP Input	CoR	Cushion Area	Thickness		
2.40 Kips	Steel	30000 Ksi	0.70	346 in ²	6.00 in		